



ROMMET®



RM600 with AdEM™ Module (Complete with 45 Light Nipples)

ROTARY GAS METERS

RM600 . RM16 . G10

TECHNICAL SPECIFICATION

	RM600 Imperial	RM16 & G10 Metric
MAOP	175 psig	1206 kPa(12 bar)
Flow Capacity	600 acfh	16 m ³ /h
Rangeability @ ±1% Error	28:1	28:1
Rangeability @ ±2% Error	60:1	60:1
Start Flow Rate	1.8 acfh	0.05 m ³ /h
Differential @ Q _{max}	0.4 IWC	1.0 mbar
Counter Resolution	1.0 cf	0.01 m ³
Instrument Drive Rate	10 cf/rev	0.1 m ³ /rev
LF Pulser (Optional on STD CTR Ver.)	10 cf/pulse	0.1 m ³ /pulse
Weight (Flange Style)	12 lbs	5.5 kg

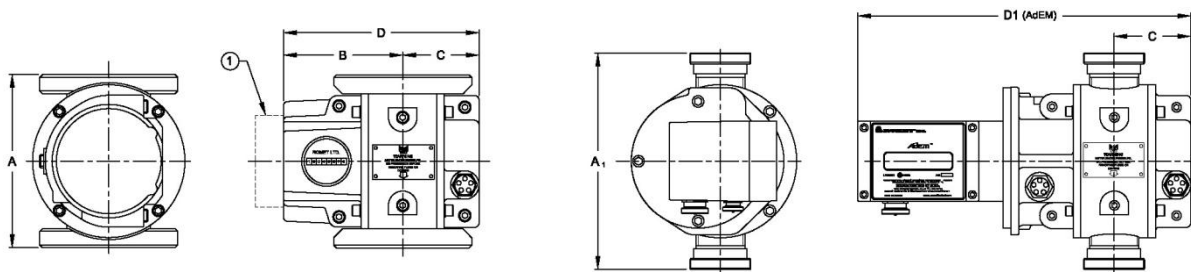

- Note: 1. Add 28 mm to dimension D for the addition of an external pulser (only available on side reading counter meters).
 2. Add 1.15" (29 mm) to dimension C and D1 for backup index option.
 3. 1.5" NPT Nipple style is available, contact Romet for more information.

Meter Model	A	A1 (45 LT NIPPLE)	B	C	D	D1	ANSI 125/150 F.F. Flange	DIN PN16 Flange
RM600 & RM16	6.75"	7.87"	5.01"	3.08"	8.09"	13.96"	2"	-
G10	171 mm	200 mm	127 mm	78 mm	205 mm	355 mm	2"	40 mm



IMAC Systems, Inc.
 90 Main Street, PO Box 1605
 Tullytown, PA 19007

1-800-955-4GAS
 Phone: (215) 946-2200
 Fax: (215) 943-2984

sales@imacsystems.com